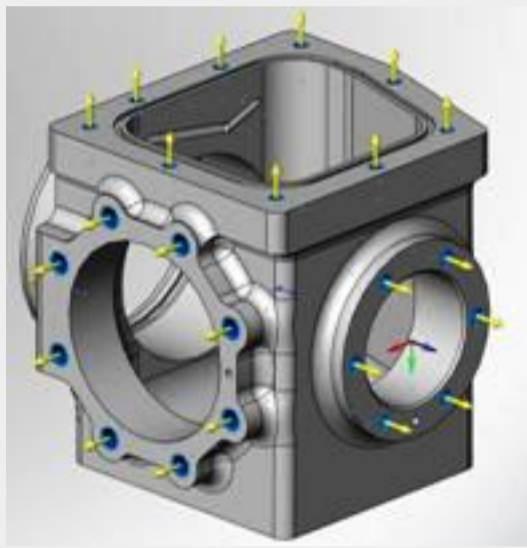

IN THIS ISSUE[Moldmakers look forward to EuroMold](#)[German Moldmaker succeeds with SolidWorks+SolidCAM](#)[Enhanced Electrode Design and Manufacturing](#)**Moldmakers look forward to EuroMold**

At the Euromold show, we will demonstrate major features of our new version SolidCAM 2010. It includes an automated 5-axis Drill operation (see *screenshot*), that accelerates the drilling of "Swiss cheese" type of parts. This will increase the productivity of mold makers, that have to drill hundreds of holes from various directions into the mold.

The timing for the Euromold exhibition is perfect, as the mold business indicates signs of recovery. The "Mold Business Index" (MBI), published by the the *Moldmaking Technology* magazine, has increased for the first time in the last two years compared with the previous quarter.

[See the latest Mold Business Index...](#)**SolidCAM infos**

- [Watch SolidCAM Professor Tutorials and Videos](#)
- [Order free Demo CD](#)

The year 2009 has been difficult for mold and die makers. Not only that the number of projects decreased, but also the prices paid for new molds steadily dropped over the last years. According to the *Moldmaking Technology* magazine (see *left column*), "this has driven many moldmakers out of business, and those that have survived have done so by becoming much more efficient. This trend will likely persist for the foreseeable future, and this will force moldmakers to become even faster, leaner and (most importantly) smarter."

A major step to increase productivity is **Seamless Integration**. Often the imaginary wall known as "data translation" stands as a barrier between product design, mold design and CAM Programming. The modern mold shop achieves maximum productivity by sharing the same 3D database and the same user environment for product designers, mold designers and CNC programmers. This seamless integration provides shorter learning curves and a greater efficiency in communicating between geometry and toolpaths. The combined solution *SolidCAM + SolidWorks 2010* is the best implementation of this concept.

Dear reader, if you are also interested to learn about our latest developments, please visit our booth at the [EuroMold show](#) in Frankfurt from Dec 2 to 5. We look forward to meet you there in **Hall 8, Booth M54**.

Emil Somekh
Managing Director
SolidCAM Ltd.

German Moldmaker succeeds with SolidWorks +SolidCAM

The German moldmaker *Lambeck + Kersten* manufactures foaming molds for applications in packaging, carrying and sanitary engineering. The final parts are made of styrofoam or polypropylene. Customers demand a high manufacturing quality and a fast time-to-market. Thanks to the integrated solution *SolidWorks+ SolidCAM* the company manufactures up to 5 foaming molds per month.



Ulrich Lambeck, one of the company's founders, summarizes: "SolidWorks as 3D CAD system has been a very good choice. It is a well-engineered 3D CAD system and almost an industrial standard. The SolidCAM software, seamlessly integrated in SolidWorks, ensures the efficient CNC programming of the individual mold parts and guarantees high-quality and fast manufacturing on our CNC milling machines, thanks to a variety of milling strategies." With the High-Speed Machining module (HSM) the CNC programming of complex molds can be significantly accelerated.

[Read more about Lambeck + Kersten...](#)**Enhanced Electrode Design and Manufacturing**

SolidCAM's Electrode solution automates time-consuming and repetitive tasks in the Electrode Design and Manufacturing process, including geometry extraction, documentation and machining. At the upcoming Euromold show, SolidCAM demonstrates new features of this solution, seamlessly integrated in SolidWorks 2010, that enables moldmakers to ensure faster delivery of their products.

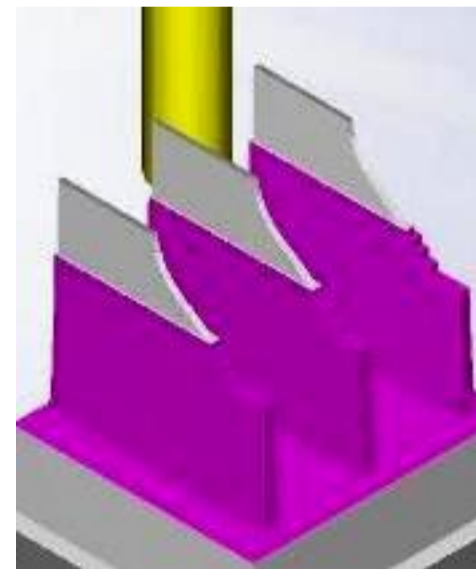

With the Electrode Solution, electrode makers can now easily design electrodes using the improved, advanced surfacing functions and techniques. Options are available to import burn profiles prior to creating extensions, creating junction surfaces, creating tangential and vertical extensions for multiple ribbed to solid electrodes, handling vertical and angular machining direction. SolidCAM 2010 contains also enhancements for the High-speed Machining (HSM) of electrodes and a new suboperation for the 5-axis Simultaneous Machining of complex electrodes. With the right degree of automation and user-control, SolidCAM's Electrode solution provides the optimal combination to streamline the electrode manufacturing process.

[Read more about it...](#)